



M82 - M72



82.617.18



82.617.19



82.617.20

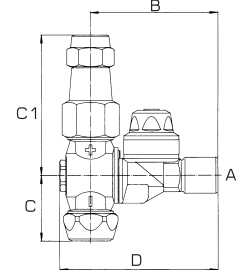
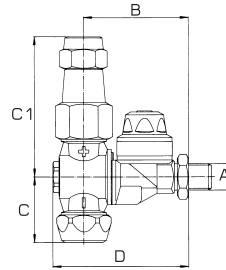

72.610.7



72.610.8



72.610.9

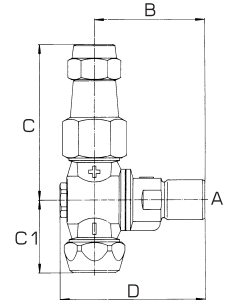
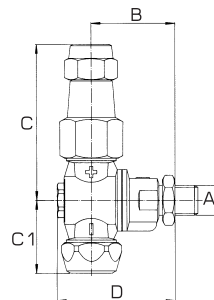

**Standard: M82 / M72 completo di ghiera e ugello AMT Ø15 foro Ø1.5 per il lato regolabile
Ugello non compreso per il lato non regolabile**

Pressione di esercizio max.: 40 bar

Peso: M82: G1/4M. 340g - G1/4F. 340g - G3/8M. 355g
M72: G1/4M. 275g - G1/4F. 275g - G3/8M. 290g

Materiali: ottone - acciaio inox - NBR - PVC M82: +FKM

Impiego: su atomizzatori. Il lato regolabile consente il trattamento di colture ad alto fusto. Due ugelli selezionabili con posizioni intermedie di chiusura. Due posizioni "APERTO" inclinate ±15° dalla verticale. Ogni posizione è segnalata da uno scatto. M82: Antigoccia resistente ed efficace a bassa e ad alta pressione.

**Standard: M82 / M72 with caps and Ø15 AMT Ø1.5 hole spray tip on adjustable end.
No spray tip mounted on the other end**

Max. operating pressure: 40 bar / 600 PSI

Weight: M82: 1/4" BSPM. 340g / 12oz. - 1/4" BSPF. 340g / 12oz - 3/8" BSPM. 355g / 12.5oz
M72: 1/4" BSPM. 275g / 9.5oz. - 1/4" BSPF. 275g / 9.5oz - 3/8" BSPM. 290g / 10oz

Materials: brass - stainless steel - Buna N - PVC M82: + FKM

Use: on air blast sprayers. The adjustable side allows spray pattern variation for high trees coverage. Rollover to select spray tips with two shut off positions. Two "OPEN" positions at ± 15° from vertical. A click point out each position. M82: Check valve assures efficient and long lasting operations at low and high pressures.

COME SI ORDINA/HOW TO ORDER

CODICE code	A	B mm	C mm	C1 mm	D mm	ORDINE MINIMO minimum order	KIT RICAMBIO spare parts kit
82.617.18	G1/4M.-1/4" BSPM.	51	32	68	66	50	
82.617.19	G3/8M.-3/8" BSPM.	51	32	68	66	50	75.302.28
	G1/8F.-1/8" BSPF.						
82.617.20	G1/4F.-1/4" BSPF.	62	32	68	77	50	
72.610.7	G1/4M.-1/4" BSPM.	37	68	32	52	50	
72.610.8	G3/8M.-3/8" BSPM.	37	68	32	52	50	70.302.27
72.610.9	G1/4F.-1/4" BSPF.	48	68	32	63	50	



TABELLA
TABLE